

NOTE:

- Use plywood backing in walls whenever possible, to ensure security to wall.
- Be sure that distance between centers of posts is correct before drilling into wall.
- Do all painting, staining or wall papering before accessory installation.

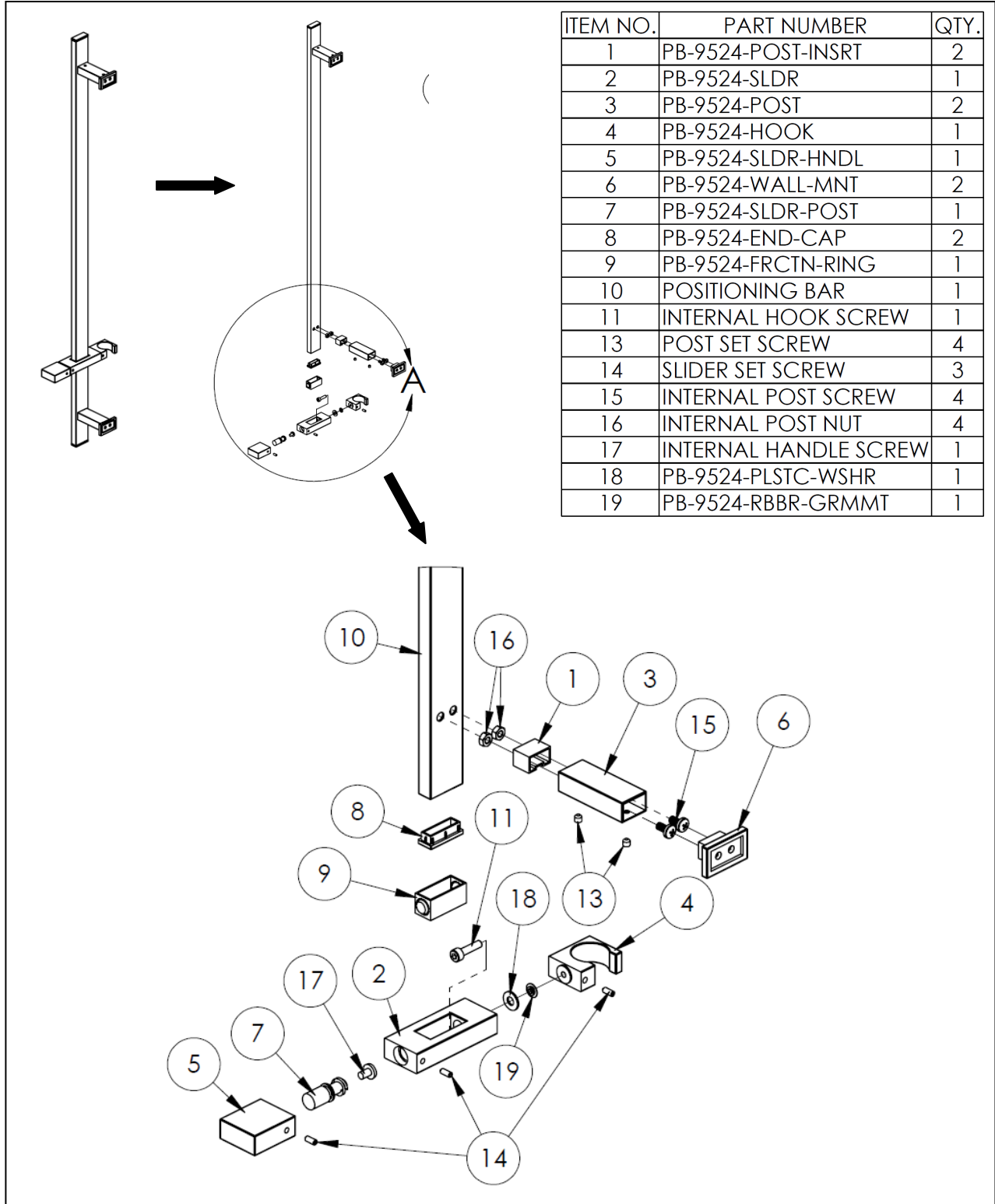

Adjustment & Installation Notes:

- Internal post nuts (16) are located inside positioning bar (10) and covered with the positioning bar end cap (8).
 - o Use a 7mm wrench inside the positioning bar (10) to hole the internal post nuts (16) in place while unscrewing with a phillips head screwdriver.
- **If the slider is not maintaining the correct position, calibration will be necessary, as follows:**
 - o 1) Remove wall bracket assembly (1, 3, 6, 15, 16) from positioning bar (10).
 - o 2) Remove slider assembly from the position bar (10).
 - o 3) Remove the plastic friction ring (9) being careful not to break or tear any plastic pieces off.
 - o 4) Remove the set screw from the slider (2).
 - This step requires a 3mm flat head screwdriver
 - o 5) Unscrew the handle assembly (5, 7, 17) from the slider (2).
 - This is a reverse thread, unscrew accordingly
 - o 6) Unscrew the internal handle screw (17) in ¼ turn increments from the slider post (7).
 - Reassemble after each adjustment to see if the slider will now hold its proper position.
 - o 7) Reverse steps to reassemble once the slider is calibrated correctly.
- **To adjust the tension of the hook (4):**
 - o 1) Repeat steps 1-5 above.
 - o 2) Remove the set screw from hook (4).
 - o 3) Using a 3mm allen key, tighten or loosen (based on adjustment needed) the internal hook screw (11).
 - You'll need to make this adjustment with the allen key through each end hole of the slider (2), which is why the handle assembly must be removed for access.
 - Be sure that the hook (4) remains square with the slider (2) while making adjustments.
 - o 4) Lock in the adjustment by reinstalling the set screw into hook (4).

IMPORTANT INSTALLATION INFORMATION

- DO NOT USE PLUMBER'S PUTTY ON ANY OF THE BRASS COMPONENTS
 - This will cause the finish to tarnish and void the warranty. A non-corrosive Alkoxy Silicone is recommended.

To help ensure the beauty of brass accessories, never install an item until construction is almost completed and after:

- Workmen have finished treating nearby tile or marble with acid or chemicals.
- The air conditioning or heat has been turned on.
- The room has been painted or stained.

For technical support or warranty information, please call 718-257-2800