



Model ID	Package Code	Description (define configuration referencing drain end)
TS3P-6030 L ABF / ADA10-REM TS3P-6030 R ABF / ADA10-REM		60" x 30", end drain, multi-piece tub-shower, with 17.25" apron, 4-bars (dual horizontal back wall bars, single horizontal bar on head end wall and on control wall) with white articulated removable seat and shower curtain rod.
	DELETE / SHWR ROD-TS	Delete shower curtain rod from ADA10 package. (DOES NOT compromise package compliance).

**Package Notes:**

1. Model available without listed package.
2. For 4-bar and folding seat package, see "ADA10-FLD" package code.
3. For 5-bar (with vertical entry bar) and seat package, see "ANS09" package code.
4. For 2, 3, 4, and 5-bar packages without a seat, see ActivLife "BP1-60", BP2-60", "4BAR", and "5BAR" packages codes.
5. For REINFORCEMENT ONLY for bars (based on ADA10 package less seat), see ActivLife "FH" package code.
6. For expanded reinforcement package options, (with or without listed package components), see ActivLife "3SM" and "3SF" package codes.

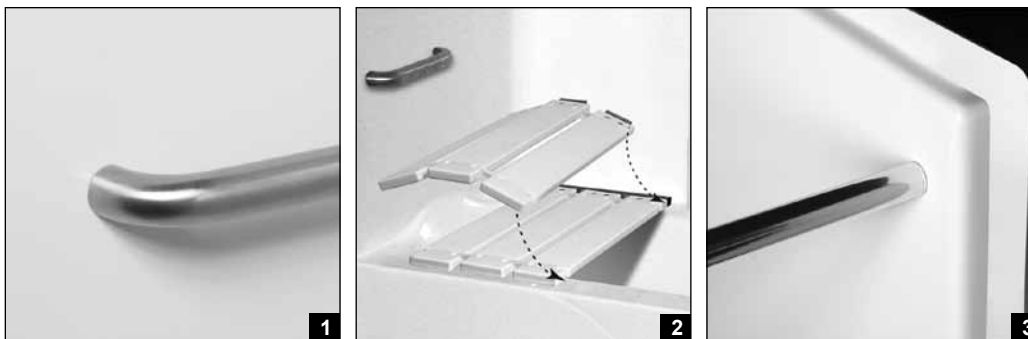
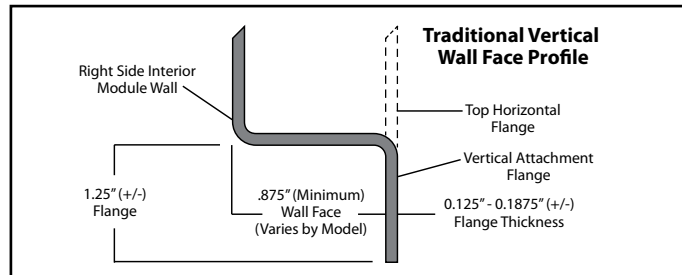

Photo 1: Grab Bars: Factory-installed 1.50-inch diameter, concealed attachment, 18 gauge, #304 brushed stainless steel grab bars. Concealed attachment design provides tamper-resistance and minimizes debris collection areas at contact points, compared to common exposed flange bar designs, without compromising bar attachment integrity. (Reinforced areas include a structural core material encapsulated in FRP composite.)

Photo 2: REMOVABLE In-Tub Seat: Factory-installed stainless steel (back wall) bracket provides stable and secure locking for removable slatted bench seat. The individual seat slats are a molded, non-porous plastic linked together by a slat-to-slat hinge mechanism. The seat articulates for easy insertion and removal from bracket and folds for convenient storage. (Bracket reinforced area is a structural core material encapsulated in FRP composite.)

Photo 3: Shower Curtain Rod: Factory-installed 1.00-inch diameter, concealed attachment, 18 gauge, stainless steel shower curtain rod with polished finished.